

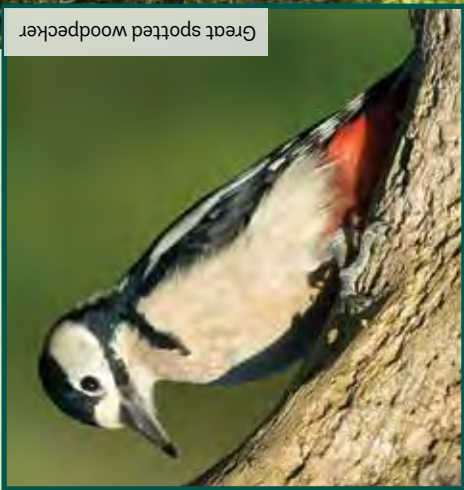

Muntjac deer



Great spotted woodpecker

The wood is teeming with a diverse range of wildlife. Listen for the song of the song thrush and the hammering of the great spotted woodpecker, just two of the many species of woodland birds who make their home here. You might even catch a glimpse of the elusive muntjac, roe or red deer that wander through the wood.

Some interesting facts

The first recorded mention of Old Wood was in the Domesday Book in 1086 when it was referred to as 'The Lound', from the Old Norse word 'lundr', meaning 'sacred grove'. A number of local farm names also originate from Old Norse, including Carr Farm which derives from 'kjarr', meaning 'forest'; and Hagg Farm in which 'hagg' refers to 'an area of felled coppice'.

On the record

Over 20 species of butterfly; 8 species of dragonfly; 38 species of bird and 271 plant species, including more than 30 ancient woodland indicator species, have been recorded in the wood.



WTML/Phil Formby

Birds of prey

Look out for buzzards, tawny owls and, if you're lucky, the hobby which is a true master of the air – hunting dragonflies and even taking small birds on the wing.

Once a deer park

In the Middle Ages the wood was enclosed by a ditch boundary and turned into a deer park. Fourteenth-century court rolls tell how 'six knights from Retford' broke down the fences to hunt deer. The park remained in use until the seventeenth century.



WTML/Amy Lewis

Finding Old Wood

Location: Only 8km (5 miles) from Lincoln, Old Wood lies close to the village of Skellingthorpe.



Directions

By car: From Lincoln, follow Carholme Road (A57) for 2km (1.25 miles) to a roundabout, exiting onto the A46. On reaching the next roundabout after 2.8km (1.75 miles) choose the fourth exit onto Lincoln Road, continuing for 1.5km (1 mile) to reach Skellingthorpe. Old Wood is 1.5km (1 mile) west of the village.

Parking: There is no on-site car park, but parking is available at the village community centre.

By bicycle: Old Wood can be accessed from Route 64 on the Sustrans National Cycle Network and bikes hired from either Hire Bike Lincoln (hirebikelincoln.co.uk) in the Skellingthorpe Community Centre car park or Doddington Hall (doddingtonhall.com), where Route 64 is accessed via the Georgie Twigg Track.

For more information visitlincoln.com/cycling.

Do you love trees?

To find more wonderful woods to explore, get inspiring ideas for woodland adventures, or help us protect native woodland and its wildlife, visit: woodlandtrust.org.uk or call 0330 333 3300.

The Woodland Trust logo is a registered trademark. The Woodland Trust is a charity registered in England and Wales number 294344 and in Scotland number SC038885. A non-profit making company limited by guarantee. Registered in England number 1982873. Map © Crown Copyright 2017. All rights reserved. OS Licence number 100021607. Cover image: WTML/Rachel Lee 10029 10/17

Old Wood is a 93-hectare haven, close to the village of Skellingthorpe and bordering Route 64 of the Sustrans National Cycle Network. This beautiful, ancient woodland is rich in native oak, lime and hazel and in spring the woodland floor is carpeted with wild flowers, including bluebell, orchid and lily-of-the-valley. The display continues into summer with dog's mercury and enchanters' nightshade. It has a fascinating history, having once been a haunt of the Vikings. Don't miss the carved sculptures nestled among the trees as you explore.

A Lincolnshire gem,
waiting to be discovered
Old Wood



WOODLAND
TRUST

Explore Old Wood

There is an extensive network of trails through the wood, including The Odin Trail, a family-friendly, surfaced cycle loop. Waymarkers on the 1.6km (one-mile) route guide you round the trail, taking in the striking carved arch and sculptures, along with the all-important picnic area.

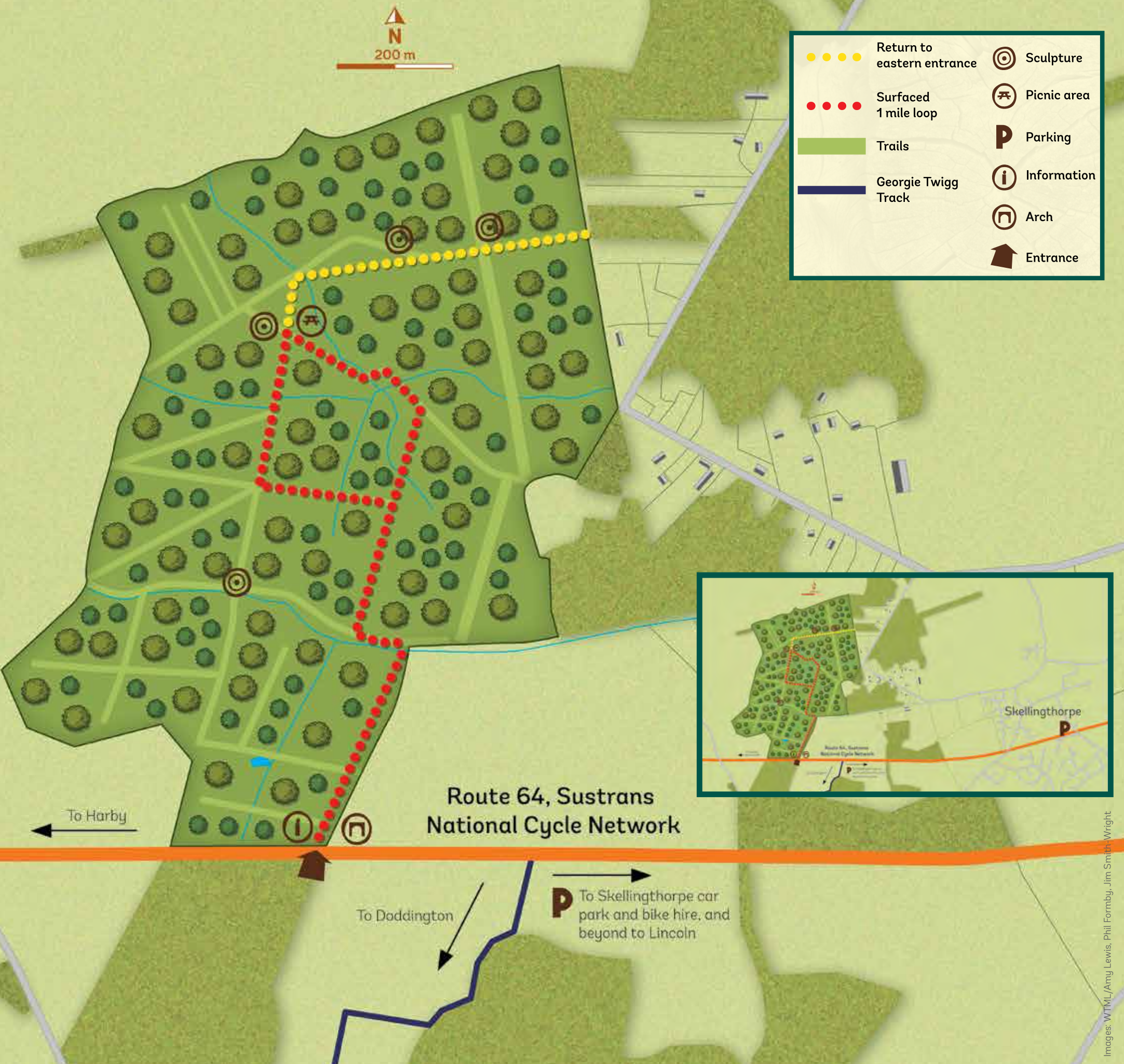

Images: WTM/L/Amy Lewis, Phil Formby, Jim Smith-Wright

Song thrush



White admiral butterfly



The Old Man of the Wood



Early purple orchid

